

## Condiment & Support Carts

CLC-100: Condiment Cart  
CLS-100: Hand Sink Support Cart

Carts of Colorado offers a versatile line of condiment and support carts to enhance any food and beverage operation. These functional carts uphold your high-end image while allowing you to smoothly run an organized and efficient business. Carts of Colorado offers customization options to meet any need.

### Condiment Cart

#### Standard Features:

- Laminate decktop
- Wood veneer body panels
- Locking storage
- Bistro awning header
- Low voltage lighting in awning
- 6" locking casters
- Base electrical: 120 volts, 15 amps

#### Optional Features:

- Solid surface countertop
- Granite countertop
- Condiment holder display (angled for easy view)
- 6' slotted crocks
- 1/6th-size pans for assorted condiments

### Hand Sink Support Cart

#### Standard Features:

- Laminate countertop
- Wood veneer exterior
- Towel dispenser
- Soap dispenser
- 10" x 10" x 6" hand sink
- 5-gallon water tank
- 7.5-gallon waste tank
- Hot water heater
- Water pump
- 6" locking casters
- Base electrical: 120 volts, 20 amps

#### Optional Features

- Solid surface countertop
- Granite countertop



Condiment Cart  
CLC-100



Hand Sink Support Cart  
CLS-100

# Condiment & Support Carts

CLC-100: Condiment Cart

CLS-100: Hand Sink Support Cart

## Condiment Cart – CLC-100

Base electrical: 120/15 amp

Top View

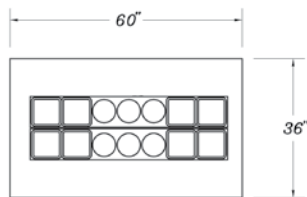

Front View

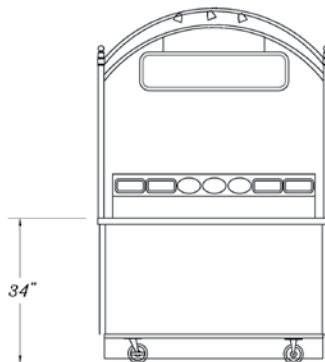

End View

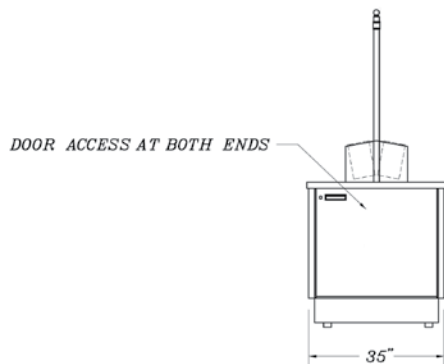

## Hand Sink Support Cart – CLS-100

Base electrical: 120/20 amp

Top View

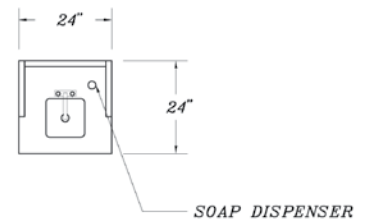

Front View

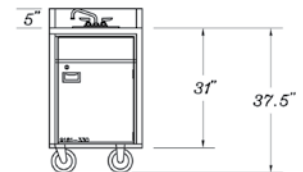

End View

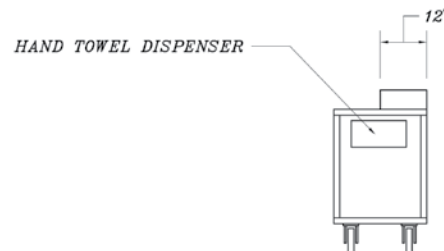

The dimensions given are reference dimensions only. Critical dimensions should be brought to the attention of the salesperson. Due to a continuous program of product improvement, Carts of Colorado reserves the right to make product changes without notice.

Installation of electrical at site not included. Buyouts provided by others do not include electrical outlets unless specified on drawing. Electrical of over 120 volts/20 amps does not include cord and cap.

This document contains information that is confidential and proprietary to Carts of Colorado and shall not be reproduced or transferred to other documents or disclosed to others or used for any purpose other than that for which it was obtained without the expressed written consent of Carts of Colorado.

It is recommended that local building, health and zoning codes be researched prior to ordering. Due to a continuous program of product improvement, Carts of Colorado reserves the right to make changes in design and in specifications without notice.

5420 S. Quebec St.  
Suite 204  
Greenwood Village, CO 80111  
(303) 329-0101  
(800) 227-8634  
Fax: (303) 329-6577  
[www.cartsofcolorado.com](http://www.cartsofcolorado.com)  
[sales@cartsofcolorado.com](mailto:sales@cartsofcolorado.com)